

Product Model LGS2000-F-16GE4GF-M

Product Image



Product Overview

LGS2000-F-16GE4GF-M is an industrial managed Gigabit Ethernet switch of Leagrid, providing 16 Gigabit Ethernet ports and 4 Gigabit optical ports. It has complete Ethernet switching performance and exceptional Layer 2 network functions, including VLAN , STP/RSTP , SNMP, IGMP , QoS, ACL and other advanced Layer 2 switch functions, while providing WEB/ Telnet/Console/CLI and other network management as well . The product adopts industrial-grade devices and shell to ensure long-term stable, reliable and safe use in harsh environments. It is deeply trusted and respected by users in transportation, electricity, telecommunications, public security, petroleum and petrochemicals, banking, coal, water conservancy, railways, metallurgy, military, civil aviation and other industrial applications.

Technical Specification

<p>Ethernet Store and forward,L2 wire-speed/non-blocking switching engine</p> <p>Standard IEEE 802.3 10Base-T , IEEE 802.3u 100Base-Tx IEEE 802.3ab 1000Base-T , IEEE 802.3z 1000Base-X IEEE802.1D STP,IEEE802.1W RSTP , IEEE 802.1s MSTP IEEE802.3X(Full Duplex)and Back-Pressure(Half Duplex) IEEE802.1Q tag-based VLANs , IEEE802.1ad Double Tagging(Q in Q)</p> <p>Switch Properties MAC Table: 8K MAX VLANs: 4K Packet Forwarding Rate:4Mpps Switching Delay: <5us</p> <p>Interface Fiber Ports: 4 1000Base-X (SFP) RJ45 Ports: 16 10/100/1000 Base-Tx RJ45 ports</p> <p>Multicast protocols IGMP V1 / V2 / V3 IGMP snooping and querying Immediate leave and leave proxy Throttling and filtering IEEE802.1ab Link layer Discovery Protocol(LLDP)</p>	<p>Traffic management &Qos IEEE802.1P Qos Number of queues per port 8 SPQ,WRR,SPO+WRR port-based shaping</p> <p>Security IP and MAC-based access control IEEE802.1X Authentication Network Access Control Multicast/Broadcast/Flooding Storm Control</p> <p>Management Cisco-like CLI (command line interface) WEB-based Management SNMP v1, v2 and v3 Telnet,HTTPS , SSH Web for Configuration Import/Export, Web for Firmware Upgrade Syslog</p> <p>Per VLAN mirroring Ethernet Copper connection diagnostic tool SFP with DDM MIBS,Client , Server , Relay , Snooping Support NTP/SNTP Device info/status;Ethernet port status</p>	<p>Physical Characteristics Housing: Metal, fanless Protection Class: IP40 Dimensions : 63.5mmx157mmx110mm(W*H*D) Weight: 0.9kg Mounting: DIN-Rail or Panel mounting</p> <p>Power Redundant Input Terminals 12-36VDC Reverse power protection</p> <p>Indicators Power Status indication indication of power input status Ethernet port indication Link&Speed</p> <p>Industry Standard EMC: FCC CFR47 Part 15, EN55022/CISPR22, Class A EMS: IEC61000-4-2 (ESD): ±8kV (contact), ±15kV (air) IEC61000-4-3 (RS): 10V/m (80MHz-2GHz) IEC61000-4-4 (EFT): Power Port: ±4kV; Data Port: ±2kV IEC61000-4-5 (Surge): Power Port: ±2kV/DM, ±4kV/CM; Data Port: ±2kV IEC61000-4-6 (CS): 3V (10kHz-150kHz); 10V (150kHz-80MHz) IEC61000-4-16 (Common mode conduction): 30V (cont.), 300V (1s)</p>	<p>Machinery: IEC60068-2-6 (Vibration) IEC60068-2-27 (Shock) IEC60068-2-32 (Free Fall)</p> <p>Approvals CE, FCC, RoHS</p> <p>Quality Assurance MTBF: 360,000 hrs</p> <p>Warranty: 3 years</p> <p>Environmental Limits Operating Temperature:-40 to 85°C Storage Temperature: -40 to 85°C Ambient Relative Humidity: 5 to 95% (non-condensing)</p>
--	---	---	--

Power Access

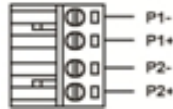

4pin 5.08mm terminals
Power Input: 12V-36VDC
P1&P2 dual redundant power supplies,
Support reverse connection protection function

Installation

DIN-rail mounting

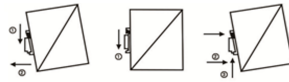

Panel mounting



Ground protection

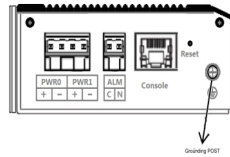

Mechanical Drawing

