

Product Model LGS2000-F-4PGE1GE1GF-I

Product Image



Product Overview

LGS2000-F-4PGE1GE1GF-I is a Gigabit POE switch of Leagrid industrial Ethernet series. It provides 4 x 1000M POE copper ports, 1 x 1000M copper port and 1 x 1000M Fiber port. The full-loading maximum power consumption is less than 4 watts (excluding POE loading). EMC level 4 can effectively resist the interference of static electricity, lightning strikes and pulses; corrugated high-strength aluminum profile shell, IP40 grade, low-power design, seismic guide rail installation, supports wide operating temperature range from -40°C to 85°C; LGS2000-F-4PGE1GE1GF-I offers fast & reliable networking and it is suitable for intelligent transportation, energy, electricity, security and other industrial applications.

Technical Specification

**Standard**

IEEE 802.3 10Base-T  
IEEE 802.3u 100Base-Tx  
IEEE 802.3ab 1000Base-T  
IEEE 802.3z 1000Base-X

**Switch Properties**

MAC Table: 8K  
Packet Buffer: 1M  
Packet Forwarding Rate: 8.928Mpps  
Switching Delay: <5us

**Interface**

Fiber Ports: 1 1000Base-X (SFP)  
RJ45 Ports: 5 10/100/1000Base-T(RJ45)

**LED**

Power LED: PWR  
Interface LED: RJ45 (Link&ACT)  
Fiber: F (Link&ACT)

**Power Requirements**

Power Terminal: 5-pin 3.81mm-spacing plug-interterminal block  
Full load power consumption: < 4W (POE <: 120W)

Overload Protection: Support  
Reverse Connection Protection: Support  
Redundancy Protection: Support

**POE Function**

IEEE 802.3.af: Supported 15.4W/port  
IEEE 802.3.af: Supported 30W/port

**Physical Characteristics**

Housing: Metal, fanless  
Protection Class: IP40  
Dimensions : 30mmx134mmx90mm(W×H×D)  
Weight: 0.50kg  
Mounting: DIN-Rail or Panel mounting

**Industry Standard**

EMI:  
FCC CFR47 Part 15, EN55022/CISPR22, Class A  
EMS:  
IEC61000-4-2 (ESD): ±8kV (contact), ±15kV (air)  
IEC61000-4-3 (RS): 10V/m (80MHz-2GHz)  
IEC61000-4-4 (EFT): Power Port: ±4kV; Data Port: ±2kV

IEC61000-4-5 (Surge): Power Port: ±2kV/DM, ±4kV/CM; Data Port: ±2kV  
IEC61000-4-6 (CS): 3V (10kHz-150kHz); 10V (150kHz-80MHz)  
IEC61000-4-16 (Common mode conduction): 30V (cont.), 300V (1s)

**Machinery:**

IEC60068-2-6 (Vibration)  
IEC60068-2-27 (Shock)  
IEC60068-2-32 (Free Fall)

**Approvals**

CE, FCC, RoHS

**Quality Assurance**

MTBF: 360,000 hrs

**Warranty: 3 years**

**Environmental Limits**

Operating Temperature: -40 to 85°C  
Storage Temperature: -45 to 85°C  
Ambient Relative Humidity: 5 to 95% (non-condensing)

Installation

Power Access

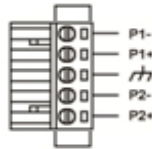

5pin 3.81mm terminals  
Power Input: 48V-52VDC  
P1&P2 dual redundant power supplies,  
Support reverse connection protection function

DIN-rail mounting

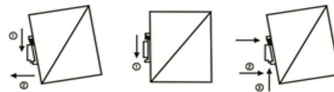

Panel mounting



Ground protection

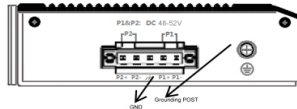

Machanical Drawing

