

**Product Model** LGS2000-F-8GE2GF-T

**Product Image**



**Product Overview**

LGS2000-F-8GE2GF-T is a full Gigabit Ethernet switch, not only providing 8 Gigabit Ethernet ports for upgrading the existing network infrastructure, but also providing 2 Fiber ports for various applications such as new energy or surveillance with better redundancy. A full Gigabit network provides a higher bandwidth than the legacy Fast Ethernet network and reduces the response time for time-sensitive applications. It supports IEEE 1588. With the powerful features, LGS2000-F series managed switches can easily to prioritize, partition and organize the network to provide reliable and high-quality services.

**Technical Specification**

**Ethernet**  
Store and forward, L2 wire-speed/non-blocking switching engine

**Standard**  
IEEE 802.3 10Base-T, IEEE 802.3u 100Base-Tx  
IEEE 802.3ab 1000Base-T, IEEE 802.3z 1000Base-X  
IEEE 802.1D STP, IEEE 802.1W RSTP, IEEE 802.1s MSTP  
IEEE 802.3X (Full Duplex) and Back-Pressure (Half Duplex)  
IEEE 802.1Q tag-based VLANs, IEEE 802.1ad Double Tagging (Q in Q)

**Switch Properties**  
MAC Table: 8K  
MAX VLANs: 256  
Packet Forwarding Rate: 4Mpps  
Switching Delay: <5us

**Interface**  
Fiber Ports: 2 1000Base-X (SFP)  
RJ45 Ports: 8 10/100/1000 Base-Tx RJ45 ports

**Multicast protocols**  
IGMP V1 / V2 / V3  
IGMP snooping and querying  
Immediate leave and leave proxy  
Throttling and filtering  
IEEE 802.1ab Link Layer Discovery Protocol (LLDP)  
IEEE 1588 PTP BC and TC  
9K Jumbo frames  
L2 wire-speed switching engine  
4K MAC forwarding addresses  
Network redundant Port Trunking, Spanning tree (STP, RSTP & MSTP), and Ring protection (< 20 ms)

**Traffic management & Qos**  
IEEE 802.1P Qos  
Number of queues per port: 8  
SPQ, WRR, SPQ+WRR  
port-based shaping

**Security**  
IP and MAC-based access control  
IEEE 802.1X Authentication Network Access Control  
Multicast/Broadcast/Flooding Storm Control

**Management**  
Cisco-like CLI (command line interface)  
WEB-based Management  
SNMP v1, v2 and v3  
Telnet, HTTPs, SSH  
Web for Configuration Import/Export.  
Web for Firmware Upgrade  
Syslog  
Port VLAN mirroring  
Ethernet Copper connection diagnostic tool SFP with DDM  
MIBS, Client, Server, Relay, Snooping  
Support NTP/SNTP  
Device info/status/Ethernet port status

**Physical Characteristics**  
Housing: Metal, fanless  
Protection Class: IP40  
Dimensions: 63.5mm x 157mm x 110mm (W x H x D)  
Weight: 0.45kg  
Mounting: DIN-Rail or Panel mounting

**Power**  
Redundant Input Terminals  
12-36VDC  
Reverse power protection

**Indicators**  
Power Status indication  
Ethernet port indication  
Link & Speed

**Industry Standard**  
EMC:  
FCC CFR47 Part 15, EN55022, CISPR22, Class A  
EMS:  
IEC61000-4-2 (ESD): ±8kV (contact), ±15kV (air)  
IEC61000-4-3 (RS): 10V/m (80MHz-2GHz)  
IEC61000-4-4 (EFT): Power Port: ±4kV, Data Port: ±2kV  
IEC61000-4-5 (Surge): Power Port: ±2kV/DM, ±4kV/CM, Data Port: ±2kV  
IEC61000-4-6 (CS): 3V (10kHz-150kHz), 10V (150kHz-80MHz)  
IEC61000-4-16 (Common mode conduction): 30V (cont.), 300V

**Machinery:**  
IEC60068-2-6 (Vibration)  
IEC60068-2-27 (Shock)  
IEC60068-2-32 (Free Fall)

**Approvals**  
CE, FCC, RoHS

**Quality Assurance**  
MTBF: 360,000 hrs  
Warranty: 3 years

**Environmental Limits**  
Operating Temperature: -40 to 85°C  
Storage Temperature: -40 to 85°C  
Ambient Relative Humidity: 5 to 95% (non-condensing)

**Installation**

Power Access

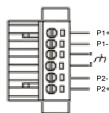

6pin 3.81mm terminals  
Power Input: 12V-36VDC  
P1&P2 dual redundant power supplies.  
Support reverse connection protection function

DIN-rail mounting

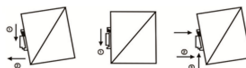

Panel mounting



Ground protection

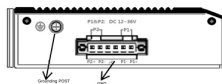

**Mechanical Drawing**

