

Product Model

LGS2000-F-8GE8GF-M

Product Image



Product Overview

LGS2000-F-8GE8GF-M is a full Gigabit Ethernet switch, not only providing 8 Gigabit Ethernet ports for upgrading the existing network infrastructure, but also providing 8 Fiber ports for various applications such as new energy or surveillance with better redundancy. A full Gigabit network provides a higher bandwidth than the legacy Fast Ethernet network and reduces the response time for time-sensitive applications. With the powerful features, LGS2000-F series managed switches can easily to prioritize, partition and organize the network to provide reliable and high-quality services.

Technical Specification

Ethernet

Store and forward, L2 wire-speed/non-blocking switching engine

Standard

IEEE 802.3 10Base-T, IEEE 802.3u 100Base-Tx
 IEEE 802.3ab 1000Base-T, IEEE 802.3z 1000Base-X
 IEEE802.1D STP, IEEE802.1W RSTP, IEEE 802.1s MSTP
 IEEE802.3X(Full Duplex) and Back-Pressure (Half Duplex)
 IEEE802.1Q tag-based VLANs, IEEE802.1ad Double Tagging(Q in Q)

Switch Properties

MAC Table: 8K
 MAX VLANs: 256
 Packet Forwarding Rate: 4Mpps
 Switching Delay: <5us

Interface

Fiber Ports: 8 1000Base-X (SFP)
 RJ45 Ports: 8 10/100/1000 Base-Tx RJ45 ports

Multicast protocols

IGMP V1 / V2 / V3
 IGMP snooping and querying
 Immediate leave and leave proxy
 Throttling and filtering
 IEEE802.1ab Link layer Discovery Protocol(LLDP)

Traffic management & Qos

IEEE802.1P Qos
 Number of queues per port 8
 SPQ, WRR, SPQ+WRR
 port-based shaping

Security

IP and MAC-based access control
 IEEE802.1X Authentication Network Access Control
 Multicast/Broadcast/Flooding Storm Control

Management

Cisco-like CLI (command line interface)
 WEB-based Management
 Syslog
 Per VLAN mirroring
 Ethernet Copper connection diagnostic tool SFP with DDM
 MIBS, Client, Server, Relay, Snooping
 Support NTP/SNTP
 Device info/status/Ethernet port status

Physical Characteristics

Housing: Metal, fanless
 Protection Class: IP40
 Dimensions: 70mmx146.5mmx171mm(W*H*D)
 Weight: 1.4kg
 Mounting: DIN-Rail or Panel mounting

Power

Redundant Input Terminals
 12-48VDC
 Reverse power protection

Indicators

Power Status indication Indication of power input status
 Ethernet port indication Link&Speed

Industry Standard

EMI:
 FCC CFR47 Part 15, EN55022/CISPR22, Class A
 EMS:
 IEC61000-4-2 (ESD): ±8kV (contact), ±15kV (air)
 IEC61000-4-3 (RF): 10V/m (80MHz-2GHz)
 IEC61000-4-4 (EFT): Power Port: ±4kV; Data Port: ±2kV
 IEC61000-4-5 (Surge): Power Port: ±2kV/DM, ±4kV/CM; Data Port: ±2kV
 IEC61000-4-6 (CS): 3V (10kHz-150kHz); 10V (150kHz-80MHz)
 IEC61000-4-16 (Common mode conduction): 30V (cont.), 300V (1s)

Machinery:

IEC60068-2-6 (Vibration)
 IEC60068-2-27 (Shock)
 IEC60068-2-32 (Free Fall)

Approvals

CE, FCC, RoHS

Quality Assurance

MTBF: 360,000 hrs

Warranty: 3 years

Environmental Limits

Operating Temperature: -40 to 85°C
 Storage Temperature: -40 to 85°C
 Ambient Relative Humidity: 5 to 95% (non-condensing)

Installation

Power Access

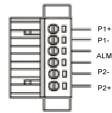

Spin 3.81mm terminals
 Power Input: 12V-48VDC
 P1&P2 dual redundant power supplies,
 Support reverse connection protection function

DIN-rail mounting

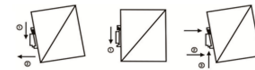

Ground protection

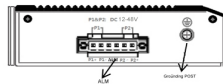

Panel mounting



Mechanical Drawing

